



Cartridge Change Instructions

QL2 Head
Without Shut-Off Valve

CARTRIDGE REMOVAL

1. Shut off water and relieve line pressure.
2. Hold head firmly. Turn cartridge to left 1/4 turn until rotation stops.

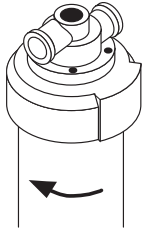

3. Pull cartridge down and out of head.

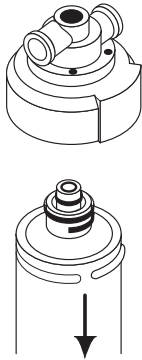

CARTRIDGE REPLACEMENT

1. Align new cartridge lug with head label. Hold head firmly. Insert new cartridge fully into head.

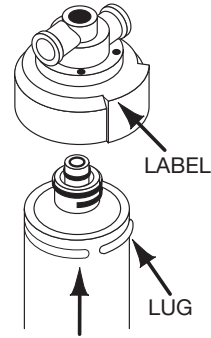

2. Turn cartridge to right 1/4 turn until rotation stops.

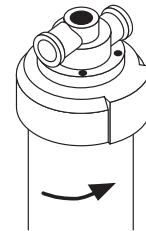

3. Turn on water supply.
4. **NOW FLUSH CARTRIDGE!** Run water through filter to drain for several minutes. **Refer to cartridge label for specific flushing time.**

For sales, replacement components, and service, contact your Everpure dealer or:
Everpure, LLC: 1040 Muirfield Drive • Hanover Park, Illinois 60133 • 800.323.7873
In Europe: Toekomstlaan 30 • B-2200 Herentals, Belgium
In Japan: Hashimoto MN Bldg. 7F • 3-25-1 Hashimoto Sagamihara-Shi • Kanagawa 229-1103, Japan

Technical Service
800.942.1153
www.everpure.com