

Approximate edge of paper shown here. Final size is 78% smaller than shown, booklet format.

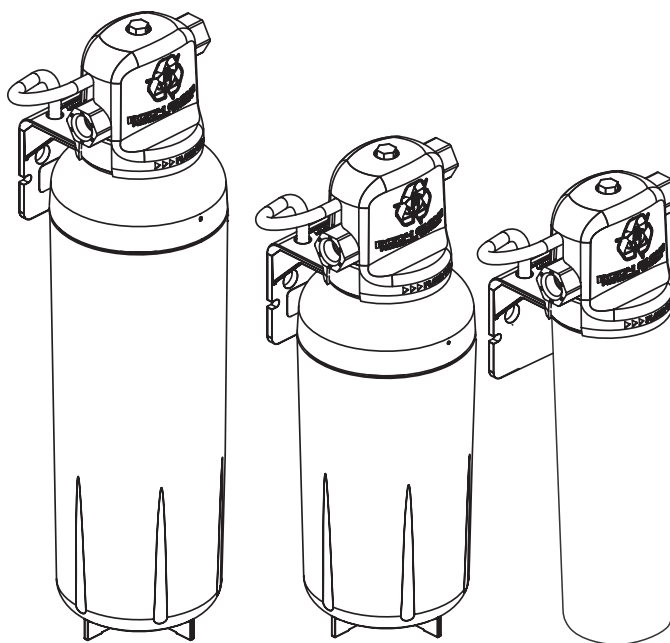

BODY GLOVE
FILTRATION SYSTEMS
FILTERED. CLEANER. BETTER.

Installation and Operating Instructions For: BG-12000, BG-3000, and BG-1000



Installer:
Please leave manual with homeowner.

Homeowner: Please retain for operation and future maintenance instructions.



Water, inc.

Internationally Distributed by Water, Inc.
Carson, CA 90746
1-800-322-WATER (9283)
<http://bodyglove.waterinc.com>

SAFETY INFORMATION

Please read and follow all safety information contained in these instructions prior to installation and use of the Body Glove BG-12000, BG-3000 and BG-1000 Systems. Retain these instructions for future reference.

Intended use:

The BG-12000, BG-3000, and BG-1000 Systems are intended for use in filtering potable water in homes and have not been evaluated for other uses. The system is typically installed under a sink, and should be installed by a qualified installer according to these installation instructions.

EXPLANATION OF SIGNAL WORD CONSEQUENCES



WARNING

Indicates a potentially hazardous situation, which, if not avoided, could result in death or serious injury and/or property damage.

CAUTION

Indicates a potentially hazardous situation, which, if not avoided, may result in property damage.



WARNING

To reduce the risk associated with ingestion of contaminants due to use with water that is microbiologically unsafe or of unknown quality:

- Do not use with water that is microbiologically unsafe or of unknown quality without adequate disinfection before or after the system.

To reduce the risk associated with hazardous voltage due to an installer drilling through existing electric wiring or water pipes in the area of installation:

- Do not install near electric wiring or piping which may be in the path of a drilling tool when selecting the position to mount the filter bracket.

CAUTION

To reduce the risk associated with property damage due to water leakage:

- **Read Use Instructions** before installation and use of this system.
- Installation and use **MUST** comply with all state and local plumbing codes.
- **Protect from freezing**, remove filter cartridge when ambient temperatures are expected to drop below 40° F (4.4° C).
- **Do not install on hot water supply lines.** The maximum operating water temperature of this filter system is 100°F (37.8°C).
- **Do not install** if water pressure exceeds 125 psi (862 kPa). If your water pressure exceeds 80 psi (552 kPa), you must install a pressure limiting valve. Contact a plumbing professional if you are uncertain how to check your water pressure.
- **Do not install** where water hammer conditions may occur. If water hammer conditions exist you must install a water hammer arrester. Contact a plumbing professional if you are uncertain how to check for this condition.
- **Do not** use a torch or other high temperature sources near filter system, cartridges, plastic fittings or plastic plumbing.
- On plastic fittings, never use pipe sealant or pipe dope. Use PTFE thread tape **only**, pipe dope properties may deteriorate plastic.
- Take care when using pliers or pipe wrenches to tighten plastic fittings, as damage may occur if overtightened.
- **Do not** install in direct sunlight or outdoors.
- **Do not** install near water pipes which will be in path of a drilling tool when selecting the position to mount the bracket.
- Do not use pliers or a pipe wrench to tighten when installing replacement cartridge.
- Mount filter vertically in such a position as to prevent it from being struck by other items used in the area of installation. For horizontal installation, additional support of the filter is required (not included).
- Ensure that the location and fasteners will support the weight of the system with water when installed.
- Ensure all tubing and fittings are secure and free of leaks.
- Do not install unit if collet is missing. Contact Water Inc. if collets are missing from any fittings.
- The disposable filter cartridge **MUST** be replaced every twelve months, at the rated capacity or if there is a noticeable reduction in flow rate, whichever occurs first.

IMPORTANT NOTES

- Failure to follow instructions will void warranty.
- Install with the inlet and outlet ports as labeled. Make sure not to reverse connections.

GETTING STARTED

Parts and Materials Included:

- Filter Cartridge
- Filter Head Assembly
- Filter Head Shroud
- (2) Quick Connect Fittings
- (1) 3/8" IPS x 1/4" Quick Connect Riser Adapter
- (2) Phillips Head Mounting Screws
- (2) Mounting Screw Star Washers
- (1) Quick Connect 1/4" Ball Valve
- 7' of 1/4" Plastic Tubing
- Faucet Adapter 3/8" x 1/4" Quick Connect Fitting
- Filter Vent Tube (Connected to Filter Head Assembly)
- Water Filter Replacement Indicator & Instructions
- Performance Indicator Device (PID) [BG-12000 only]
- (2) Quick Connect PID Fittings [BG-12000 only]
- PID Batteries & Instructions [BG-12000 only]
- Owners Manual
- Pre-rinse Flush Instruction Card
- Warranty / Extended Warranty Product Card
- Filter Recycle Instruction Card
- Warranty Service Card
- Product Performance Data Sheet (PDS)
- California Certification Sheet
- Specification Sheet

1 Filter Cartridge

2 Filter Head/Shroud

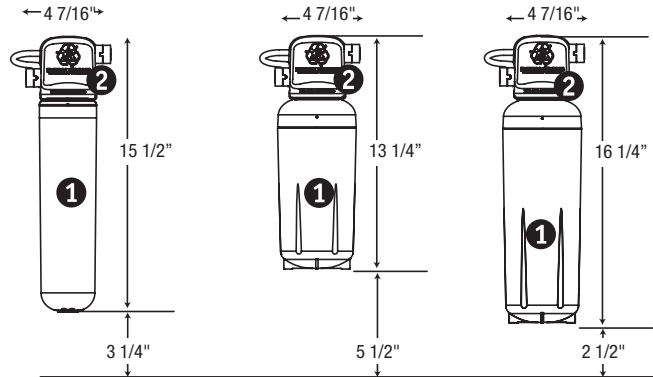

To use with all available cartridges, the cartridge must be mounted with at least the amount of space indicated.

BG-1000

BG-3000

BG-12000

Tools Required (not included):

- Drill (Cordless recommended)
- Adjustable wrench
- Phillips head screwdriver
- Razor knife or tube cutter

Additional Parts Required (not included):

- Drinking Water Faucet

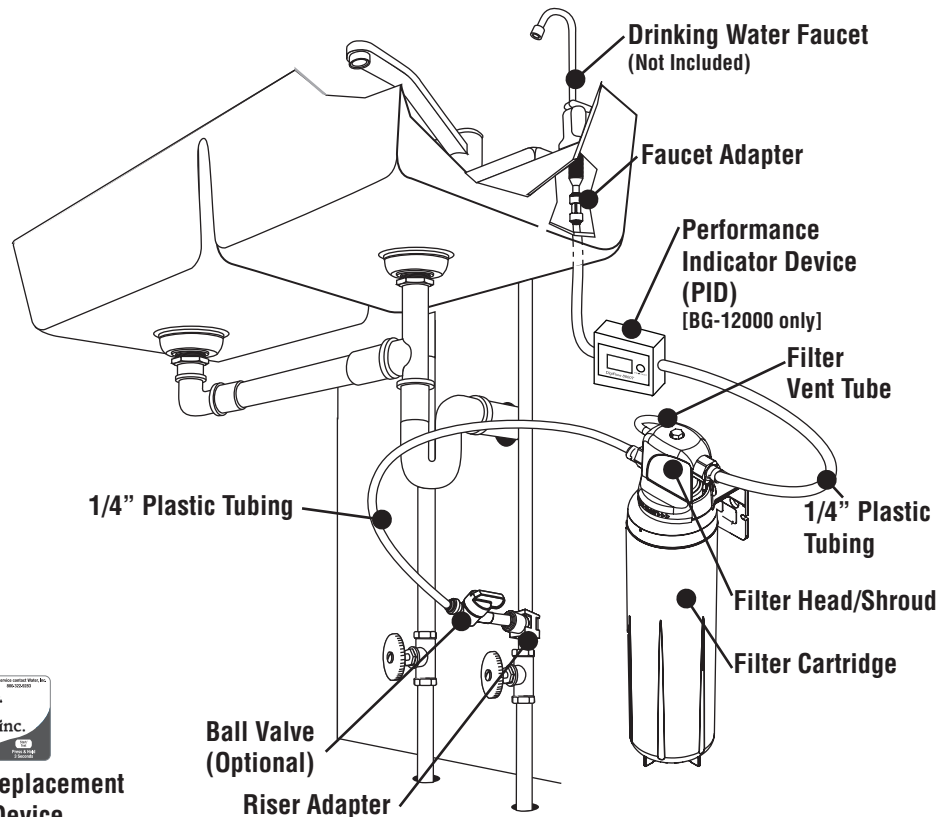

Water Filter Replacement Indicator Device

INSTALLATION INSTRUCTIONS

For Use With Cold Water Only.

NOTE: Remove items from under the sink. Place catch basin there to collect small amounts of water that may run out when disconnecting water supply lines.

1. Turn off cold water supply valve.

Install (2) quick connect fittings into head assembly using PTFE thread tape only.

2. Remove cold side riser tubing connection at angle stop. Install Quick Connect riser adapter to angle stop and reconnect riser tube to the quick connect riser adapter.

3. Select and mark a location under the sink that allows access for filter change.

Measure dimensions of location for filter to allow for the following min/max space: 6" W X 5 1/2" D X 19" H (note: if the cartridge is too tall for the base of the cabinet, a hole can be cut to allow for the filter to be changed).

4. Using filter head/bracket as a guide, mark hole locations so that there is 1 1/2" between the screws (see Figure 1), from center of each screw.

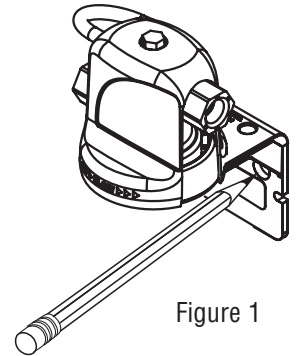

Figure 1

Install screws and washers, but only halfway, so you can easily slip the bracket to wall before firmly setting screws.

When installed, the bottom of the filter should have a minimum clearance of 2 1/2" from sink cabinet floor to facilitate cartridge change.

Fasten Filter Head Assembly to wall with Phillips head mounting screws supplied.



Correct



Incorrect

Figure 2

5. Cut tubing straight with a razor knife or tube cutter. (See Figure 2).

Determine length of tubing required from filter head/bracket to faucet and from water supply line to filter head/bracket by holding tubing in place ensuring it is of appropriate length. Do not kink tubing as this will impede water flow. If necessary, loop tubing around to avoid it being kinked.

Connect 1/4" tubing from riser adapter to inlet side of filter head. (See "Using Push-In Fittings.")

Install optional ball valve in line from water supply to filter head bracket.

BG-12000 Only: Install and mount PID (required) per instructions in section "Operation Instructions For The Digiflow 8800T Performance Indicator Device (PID).

"Using Push-In Fittings"

To Attach Tubing

- (1) Push tubing in as far as it will go.
- (2) Tubing must be inserted past o-ring and hit backstop. Pull tube to ensure it is secured.

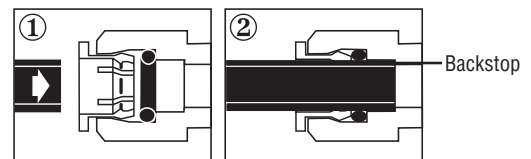

To Release Tubing

- (3) Push in collet to release tubing.
- (4) With collet held, pull tubing straight out.

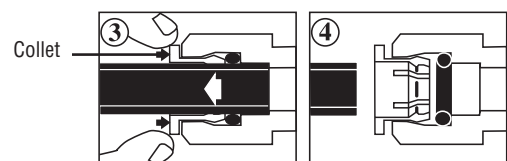

CAUTION

- To reduce the risk associated with property damage due to water leakage:
- Ensure all tubing and fittings are secure and free of leaks.

INSTALLATION INSTRUCTIONS (CONTINUED)

6. Install faucet adapter fitting to drinking water faucet (drinking water faucet not included). This should be a snug fit. **Do not overtighten.** (See Figure 3)
7. Referring to the “Using Push-In Fittings” section, insert the NSF approved tubing into the faucet adapter fitting, **making sure the end of tubing is firmly seated.**

Hold the filter head assembly away from the wall, press other end of tubing into outlet side as indicated by arrow on filter head assembly. (see Figure 4)



Typical connection shown. Refer to installation instructions for your particular fixture.

Figure 3

8. Place filter head assembly holes over mounting screws and press down to lock into place. Tighten the screws for a secure fit.
9. Insert filter into filter head assembly by aligning arrow printed on the top of cartridge label with arrow on filter head. (Note: arrow is located under the shroud on the filter head body on the inlet water side). Turn filter one quarter turn to the right until it stops. When fully engaged, the top surface of the filter will be flush with the bottom of the filter head assembly.
10. Turn on water and open filter system faucet to flush air from the system. **Run water for a minimum of 4 gallons (approximately 5 minutes) to flush system of carbon fines and release trapped air. Flush water into a bucket or pail and reuse the water for garden or landscape watering. While system is flushing, check for leaks. Repair any leaks as needed before continuing.**

Close filter system faucet. The system is now ready for use. System is now under pressure and can be inspected for leaks. Repair any leaks as needed before continuing.

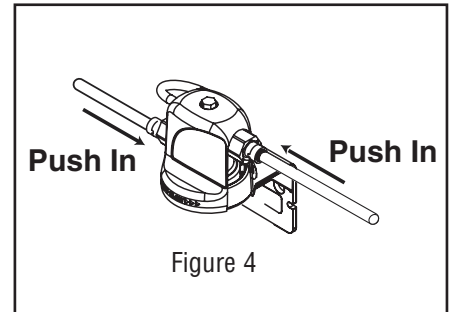

Figure 4

Note: White tube from head is a filter vent tube outlet. DO NOT remove, kink or obstruct white tube.

FILTER CARTRIDGE REPLACEMENT INSTRUCTIONS

To maximize effectiveness and to help reduce the possibility of service related issues, the disposable, environmentally friendly & recyclable filter cartridge must be replaced every twelve months. Water, Inc values your choice in the highest quality water treatment. Failure to follow these instructions may void your warranty and increase the risk of incidental water or property damage.

CAUTION

To reduce the risk associated with property damage due to water leakage:

- Do not use pliers or a pipe wrench to tighten when installing replacement cartridge.
- The disposable filter cartridge **MUST** be replaced every twelve months, at the rated capacity or if there is a noticeable reduction in flow rate, whichever occurs first.

IMPORTANT NOTE

- BG-12000 Model Only: Change filter cartridge at 12 months or 1,000 gallons, as indicated by DIGI Flow 8800T PID, whichever occurs first.

1. Place towel under filter to collect any residual water during cartridge change-out.
2. Grasp cartridge and turn to the left (counterclockwise) until cartridge comes to a complete stop (water automatically turns off). Water may leak momentarily from vent tube. This is normal. Gently pull cartridge downward to remove.
3. Remove RED sanitary protective cap from new cartridge.
4. Ensure that o-rings are present on the cartridge and are seated into grooves; moisten o-rings with water. DO NOT use any petroleum products to lubricate the o-rings.

5. Insert filter into filter head assembly by aligning arrow printed on top of cartridge label with arrow on filter head bracket. (Note: arrow is located under the shroud on the filter head bracket on the inlet water side). Turn filter cartridge one quarter turn to the right until it stops. When fully engaged, the top surface of the filter will be flush with the bottom of the filter head assembly.

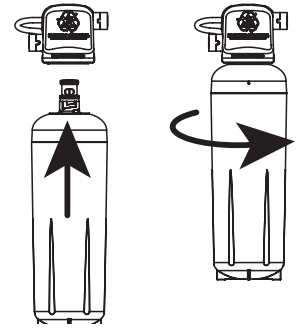

6. **Open faucet and run water for a minimum of 4 gallons (approximately 5 minutes) to flush system of carbon fines and release trapped air. Flush water into a bucket or pail and reuse the water for garden or landscape watering. While system is flushing, check for leaks. Repair any leaks as needed before continuing.**

Close filter system faucet. System is now under pressure and can be inspected for leaks. Repair any leaks as needed before continuing. The system is now ready for use.

7. **Please review section “Water Filter Replacement Indicator” for instructions on how to activate and/or test this device.**

WATER FILTER REPLACEMENT INDICATOR ACTIVATION AND USE INSTRUCTIONS (All Models):

1. Remove filter replacement indicator from plastic bag
2. To activate, press and hold “START” button for 3 seconds. LED light will flash 3 times and the alarm will beep 3 times confirming countdown has begun.
3. Mount the indicator in a convenient location using the attached magnet or double sided tape provided
4. Replace filter when LED light begins to flash once every minute or alarm beeps once every hour
5. Dispose of filter replacement indicator after the old filter has been changed. A new indicator will be included with the replacement filter.

Test Mode:

1. To test indicator at any time during the countdown period, press and hold the “START” button for 1 second. The LED light will flash once and the alarm will beep once indicating the timer is in active countdown mode.

IMPORTANT NOTE

This filter replacement indicator is designed for one-time only use.

OPERATION INSTRUCTIONS FOR THE DIGIFLOW 8800T PERFORMANCE INDICATOR DEVICE (PID) — *BG-12000 Only.*

1. Install batteries (included): Remove the battery compartment cover located on the top of the unit and install two (2) “AAA” batteries. Replace battery compartment cover. The LCD panel should now show “1,000 gal”.
2. Install fittings: The DigiFlow 8800T connection is 3/8” MNPT female. Fittings to use are 3/8” MNPT male connection which is connected to the supply and feed tubes. Install both fittings to a distance of 1/8” (0.32 cm) from flow monitor housing (see figure 2 to the right).
3. Operation: The DigiFlow 8800T turns on and shows remaining capacity on the screen when there is water flowing through it. The display on the LCD screen turns off in 10 seconds if there is no water flowing. To check the status of the remaining capacity of the installed cartridge, press the “CHECK/RESET” button.
4. End of Cartridge Life Alarm: When the remaining capacity of the installed cartridge reaches 0 gallons as indicated on the LCD screen, the PID will sound a short “beep-beep” alarm and the “0” digit on the LCD screen blinks, signaling time to replace the cartridge.
5. Reset PID: After the cartridge has been replaced, press the “CHECK/RESET” button for four (4) seconds. A long “beep” sound can be heard and the remaining capacity on the LCD screen is reset to 1,000 gallons.
6. Low Battery Power Alert: When the battery power is low and there is water flowing through the PID, a “beep-beep” sound can be heard and the empty battery symbol on the LCD screen will blink to notify the user to change the batteries. The PID will hold memory of total water flow recording while changing batteries.

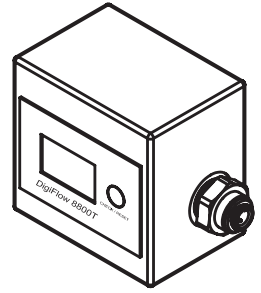

Figure 1

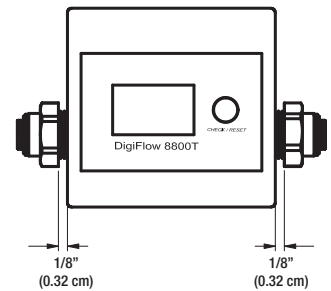

Figure 2

TROUBLESHOOTING GUIDE

Water Leaks at Push-In Connections:

Push tubing in as far as it will go. If leaking continues, shut off water at the original valve and remove water line by pushing in on the connector collet while pulling the tubing away. Inspect tubing for cracks and scratches. If tubing is cracked or scratched, simply cut that portion away and reinsert tubing into push-in fitting.

Make sure tubing is cut squarely. If not, recut correctly.

If water leaks, please verify that the o-ring is properly seated in its groove.

Water Does Not Flow From The Drinking Water System Faucet:

Check to see if the main water line valve is open, allowing water to flow to the filter. Make sure the connections are not reversed.

Water Appears Cloudy or Air Comes Out of the Drinking Water System Faucet:

Flush filter for a minimum of 4 gallons (approximately 5 minutes), to remove any carbon fines or trapped air in the filter and water lines.

For any service related issue, contact Water, Inc. at 1-800-322-WATER (9283), extensions 115 or 132

Approximate edge of paper shown here. Final size is 78% smaller than shown, booklet format.



BODY GLOVE
FILTRATION SYSTEMS
FILTERED. CLEANER. BETTER.

**For cartridge recycling information, please call
1-888-62-REUSE (73873)
or visit <http://bodyglove.waterinc.com>**

**Manufactured by 3M
Internationally Distributed by Water, Inc.
1044 East Del Amo Boulevard
Carson, CA 90746
<http://bodyglove.waterinc.com>
800-322-WATER (9283)**